



LYNCH
WOOD
PARK
PETERBOROUGH

SMALL, FLEXIBLE OFFICE SPACES

"We are excited to be launching serviced offices at Lynch Wood Park. This is a fantastic workplace and unlike anything else in Peterborough, you will love what we have to offer, internally our building is amazing, through to our beautiful gardens where staff get to enjoy quiet time or sit and work outdoors."



"Our priority at Lynch Wood Park is creating a great working environment, we offer something different from the usual serviced offices and provide that social aspect too. As a business, all your needs are met and your staff are valued."

Ryan Barber, Asset Manager

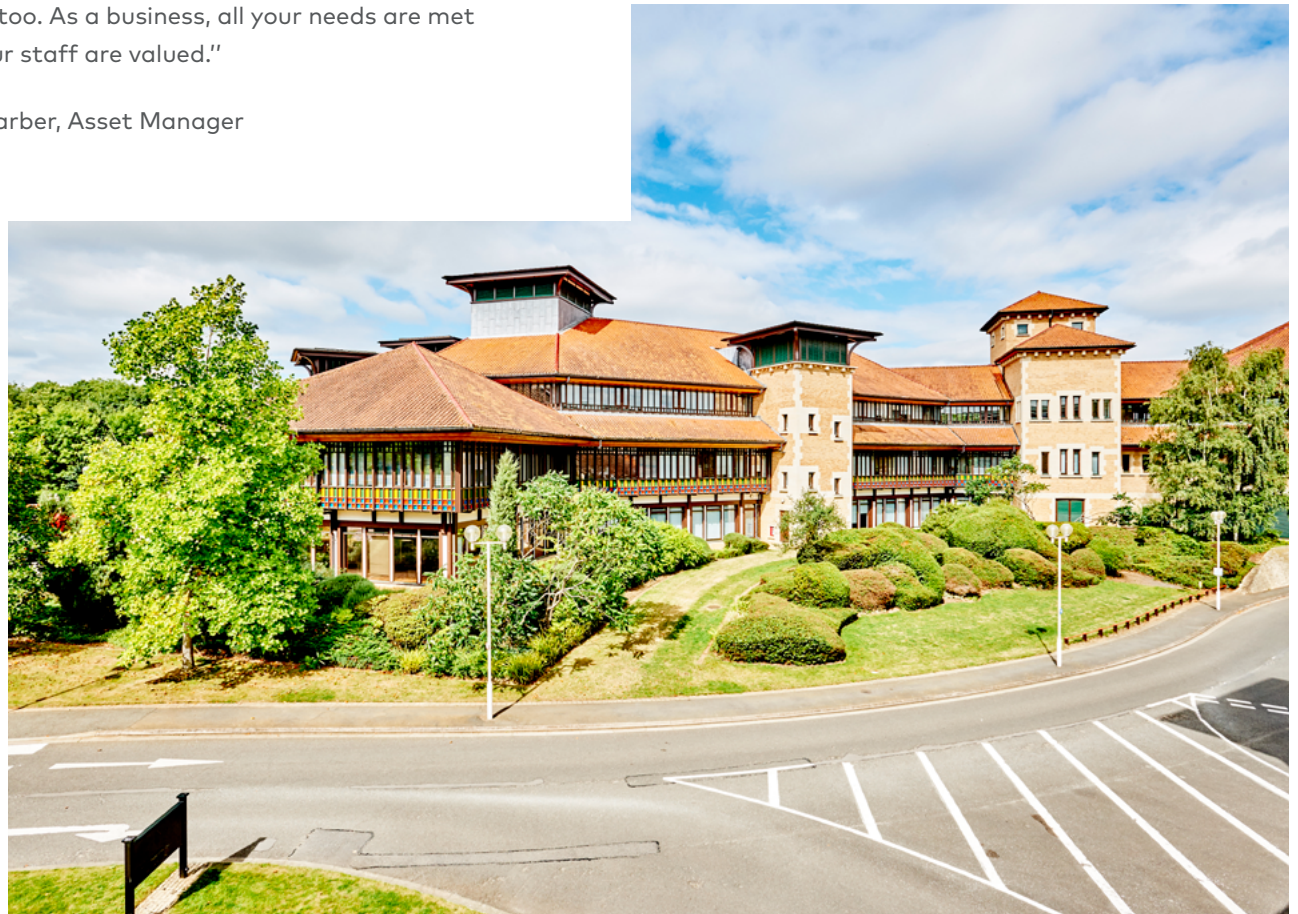

SMALL OFFICE SOLUTIONS AVAILABLE FROM £9.99 PER DAY*

For the first time ever, we have opened up flexible offices at Lynch Wood Park. Based in the heart of our business campus, these new flexible office spaces are perfect for small businesses who are looking for a new space or bigger companies who are looking for a flexible approach to their changing needs.

*Minimum three-month term required



Business
Campus



Flexible
Spaces

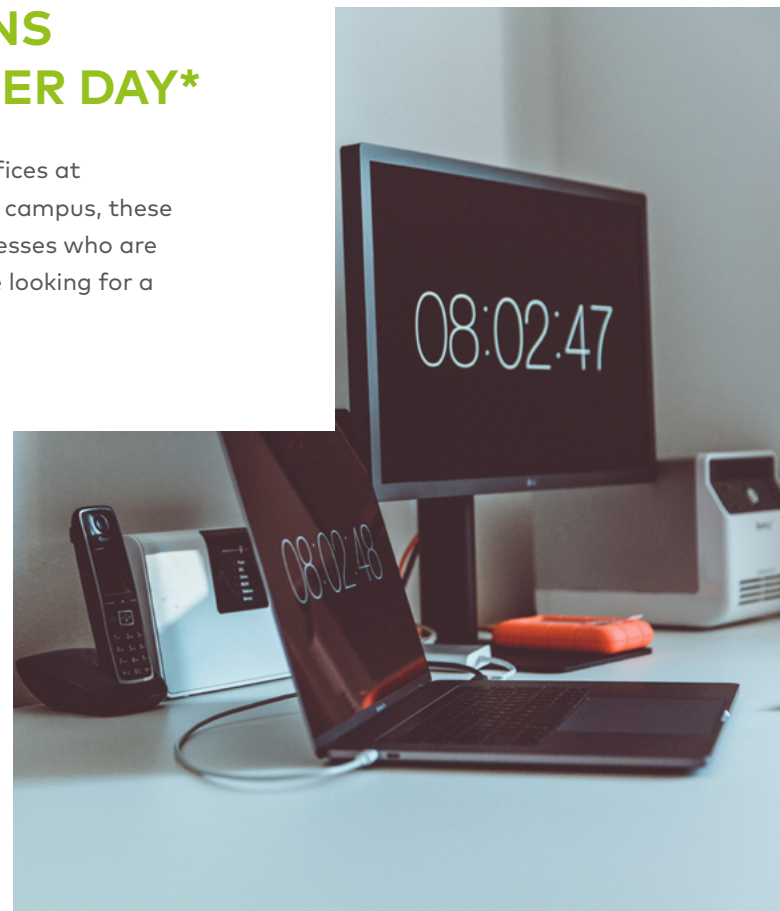
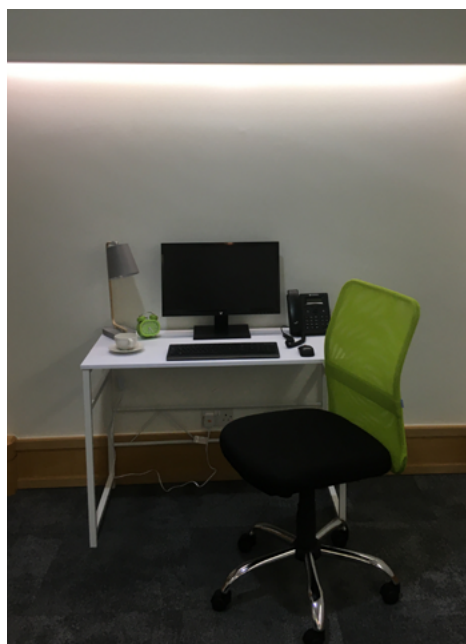

We have various sizes available for you to choose.

FROM 126 - 352 sq ft

A BIG DESTINATION FOR SMALL BUSINESSES

Our new flexible offices solution has presented small businesses with an opportunity to move into a prestigious business park and work next to Blue Chip companies.

Lynch Wood Park is a unique office campus with various on-site amenities and surrounded by mature landscaped grounds in an unrivalled tranquil setting. Lynch Wood Park is a well-connected hub, relaxing haven and thriving business community that's home to multi-national companies, small start-ups and over 2,000 employees. The site totals 350,000 sq ft with plentiful parking and is set within 11.74 hectares of landscaped gardens.

An array of community themed events throughout the year promotes a holistic collaborative approach amongst occupiers that include Diligenta, Tata, RSA, ERT and Kidney Research.





WHAT'S INCLUDED



Opportunity to be on campus with large blue-chip companies



Flexible commitments



A private office that is located on the ground floor of Lynch Wood Park



Secure office spaces



Fully serviced reception area



Surrounded by landscaped gardens



Bookable meeting rooms



Onsite staff to deal with your enquiries and needs



On-site restaurant



Award-winning parking available on-site



24-hour access available



We've been awarded



CHOOSE YOUR PERFECT SPACE

-  13 flexible offices
-  126 sq.ft smallest space available
-  352 sq.ft largest space available
-  £9.99 per day starting price*

Suite	Space (sq.ft)	Availability
178	301	LET
179	236	LET
188	126	Available
189	127	Available
190	126	LET
191	127	LET
192a	266	Available
192b	240	Available
193	326	Available
194	229	LET
195	231	LET
196	352	LET
197	231	Available

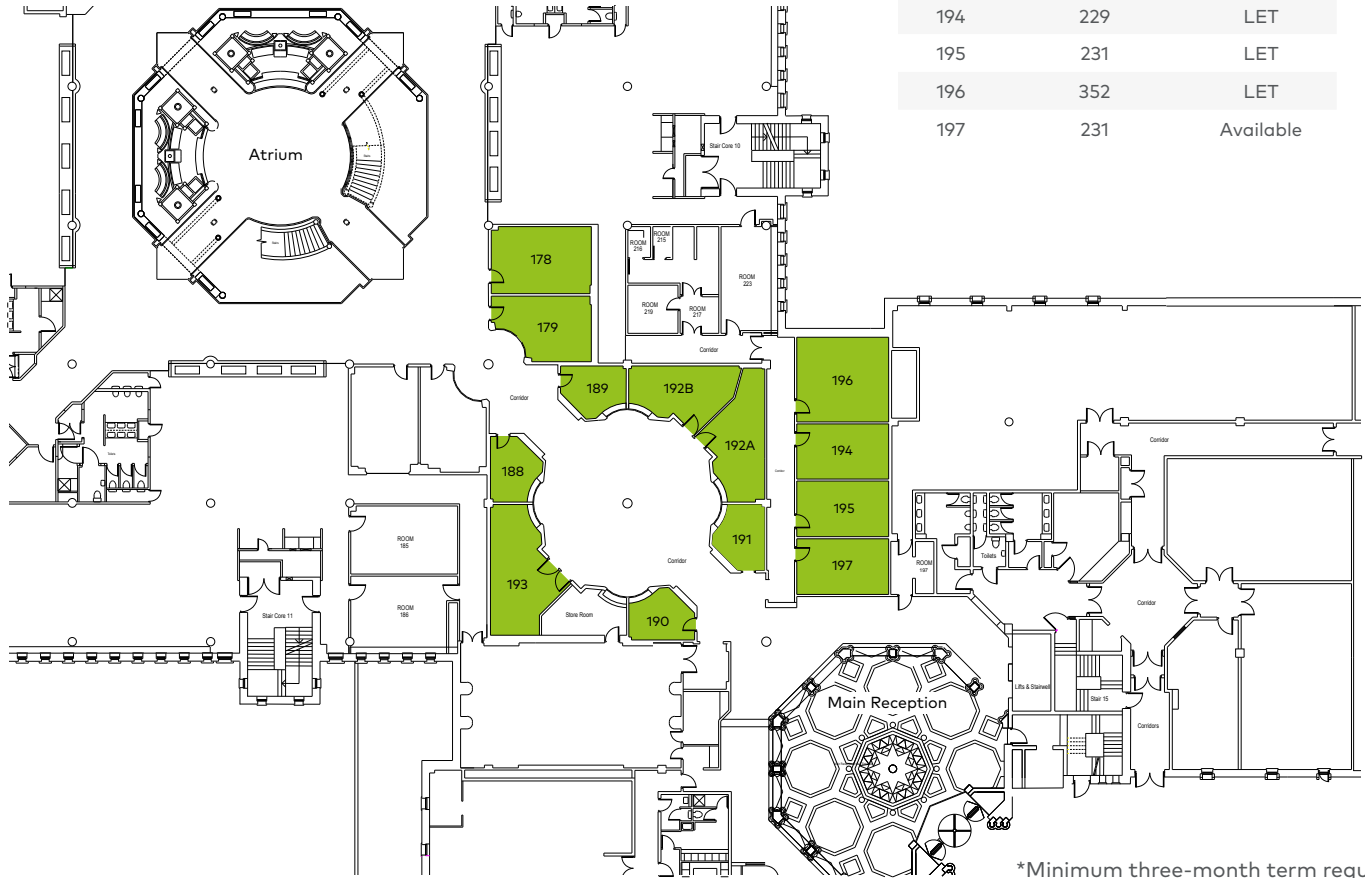

*Minimum three-month term required



INTERESTED?

Call our team today to base your business in Peterborough's primary business hub.



FI REAL ESTATE
MANAGEMENT

0845 500 61 61
www.fi-rem.com

FIREM Ltd for themselves and any joint agents, vendors or lessors of this property whose agents they are, give notice that, (i) the particulars are set out as a general outline only for the guidance of intending purchasers or lessees, and do not constitute, or any part of, an offer or contract; (ii) all descriptions, dimensions, references to condition and necessary permissions for use and occupation, and other details are given with all good faith without responsibility and any intending tenants should not rely on them as statements or representations of fact but must satisfy themselves by inspection or otherwise as to the accuracy; (iii) no person in the employment of FIREM Ltd or any joint agency has any authority to make or give any representations or warranty in relation whatever in relation to this property. October 2020.

